

Steering Column Coupling

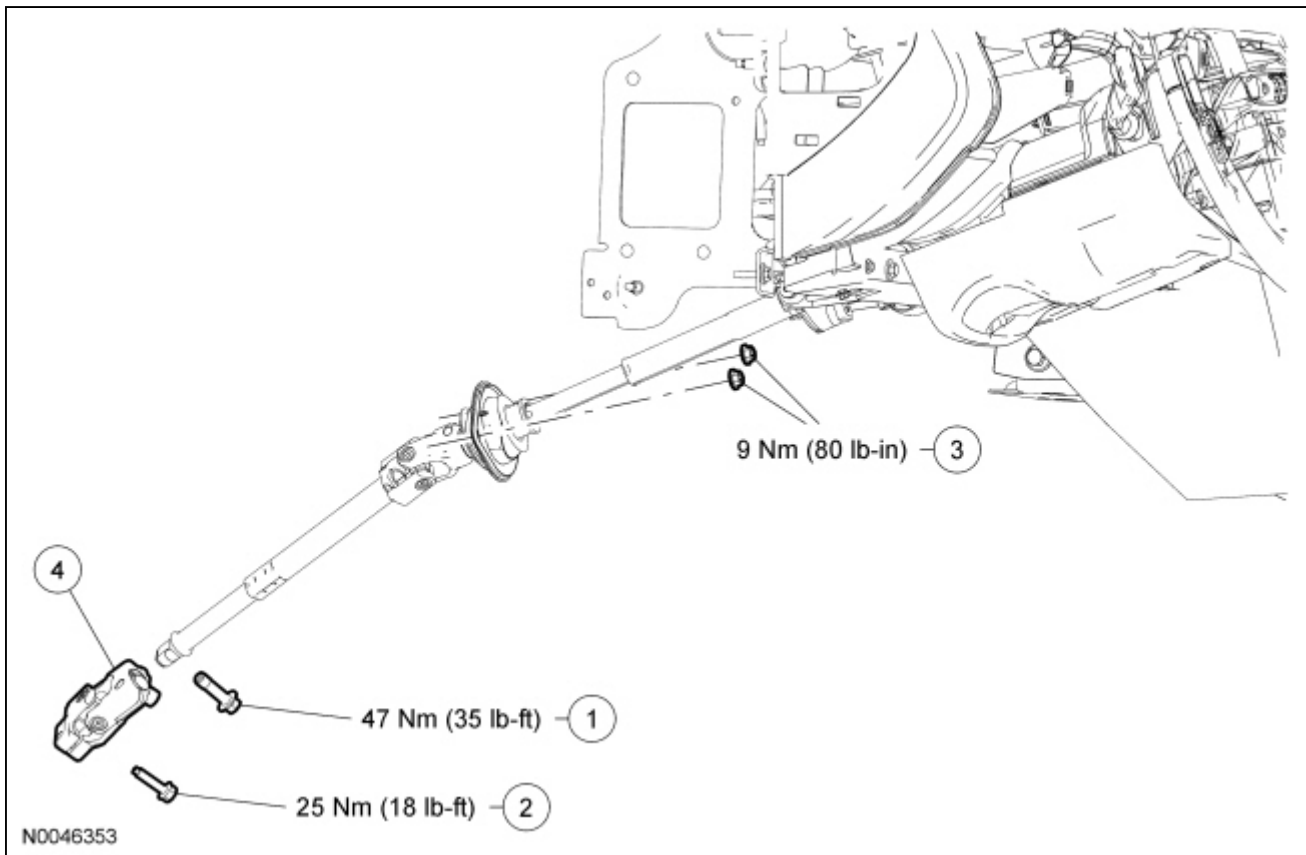

Item	Part Number	Description
1	W702600	Lower steering column shaft-to-steering column coupling bolt
2	W704980	Steering column coupling-to-steering gear bolt
3	W707137	Dash boot bearing nuts (2 required)
4	3N725	Steering column coupling

Removal and Installation

NOTICE: Do not allow the steering column to rotate while the steering column shaft is disconnected or damage to the clockspring may result. If there is evidence that the steering column shaft has rotated, the clockspring must be removed and recentered. For additional information, refer to [Section 501-20B](#).

1. With the vehicle in NEUTRAL, position it on a hoist. For additional information, refer to [Section 100-02](#).
2. Place the steering wheel in the straight-ahead position and turn the ignition switch to the OFF position.
3. Remove and discard the lower steering column shaft-to-steering column coupling bolt.
 - To install, tighten the new bolt to 47 Nm (35 lb-ft).
4. Remove and discard the steering column coupling-to-steering gear bolt.
 - To install, tighten the new bolt to 25 Nm (18 lb-ft).
5. Remove the 2 dash boot bearing nuts.
 - To install, tighten to 9 Nm (80 lb-in).

6. Collapse the upper steering column shaft slightly and disconnect the lower steering column shaft from the steering column coupling.
 7. Remove the steering column coupling.
 8. To install, reverse the removal procedure.
-